

Estriche $\geq 5 \text{ kN/m}^2$

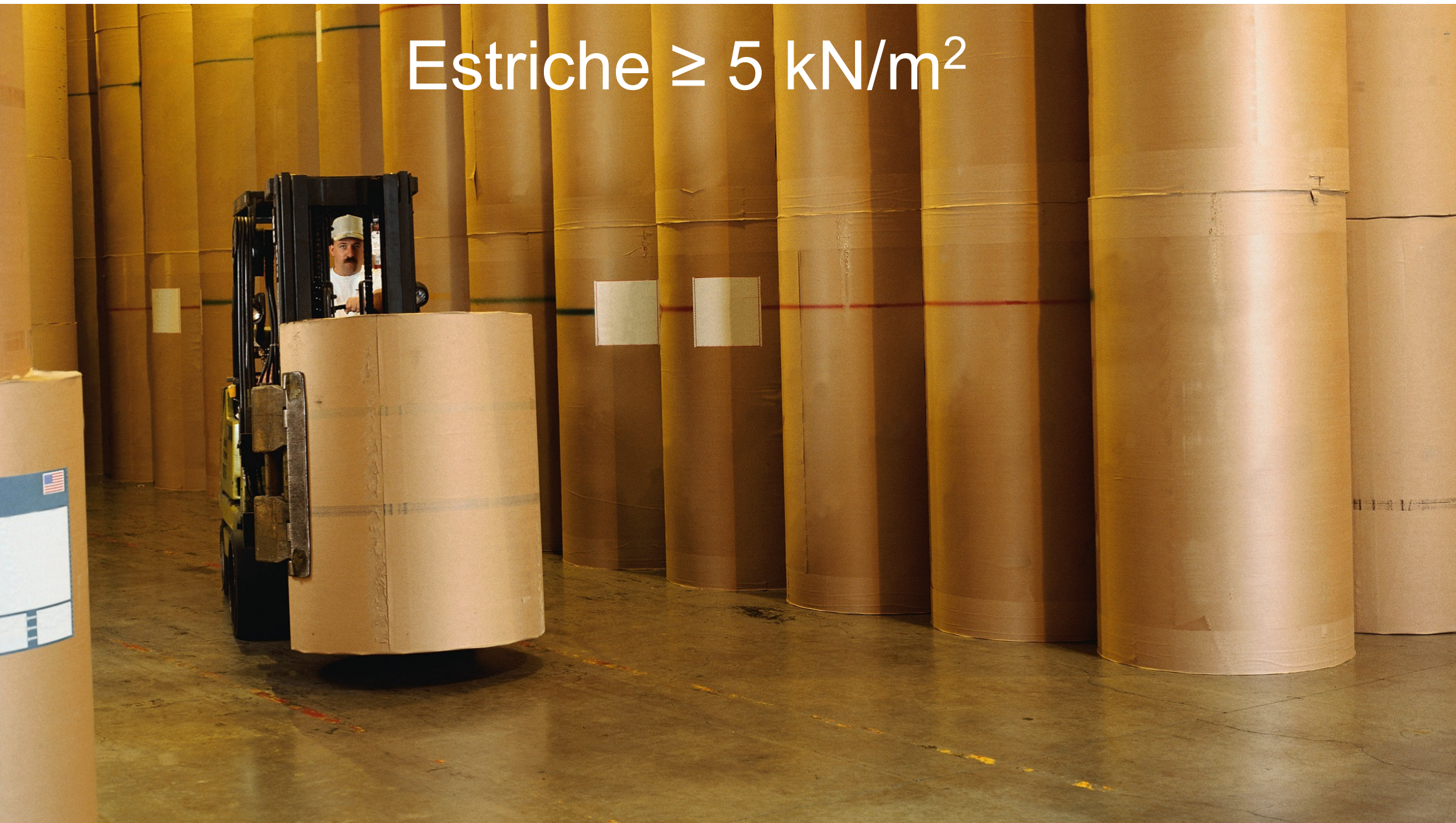

Estriche $\geq 5 \text{ kN/m}^2$



Regupol[®] sound Range

Einsatzbereich durch neue
Materialtype erweitert

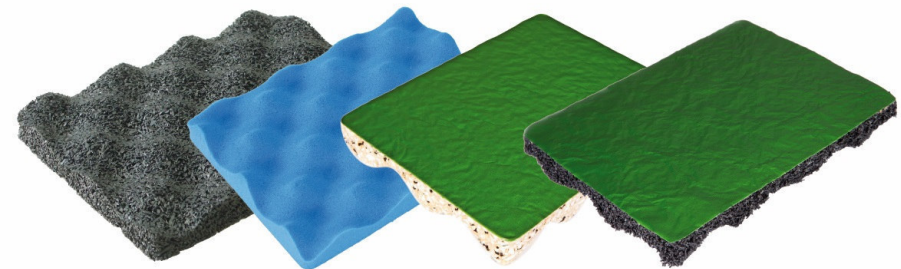

Estriche $\geq 5 \text{ kN/m}^2$

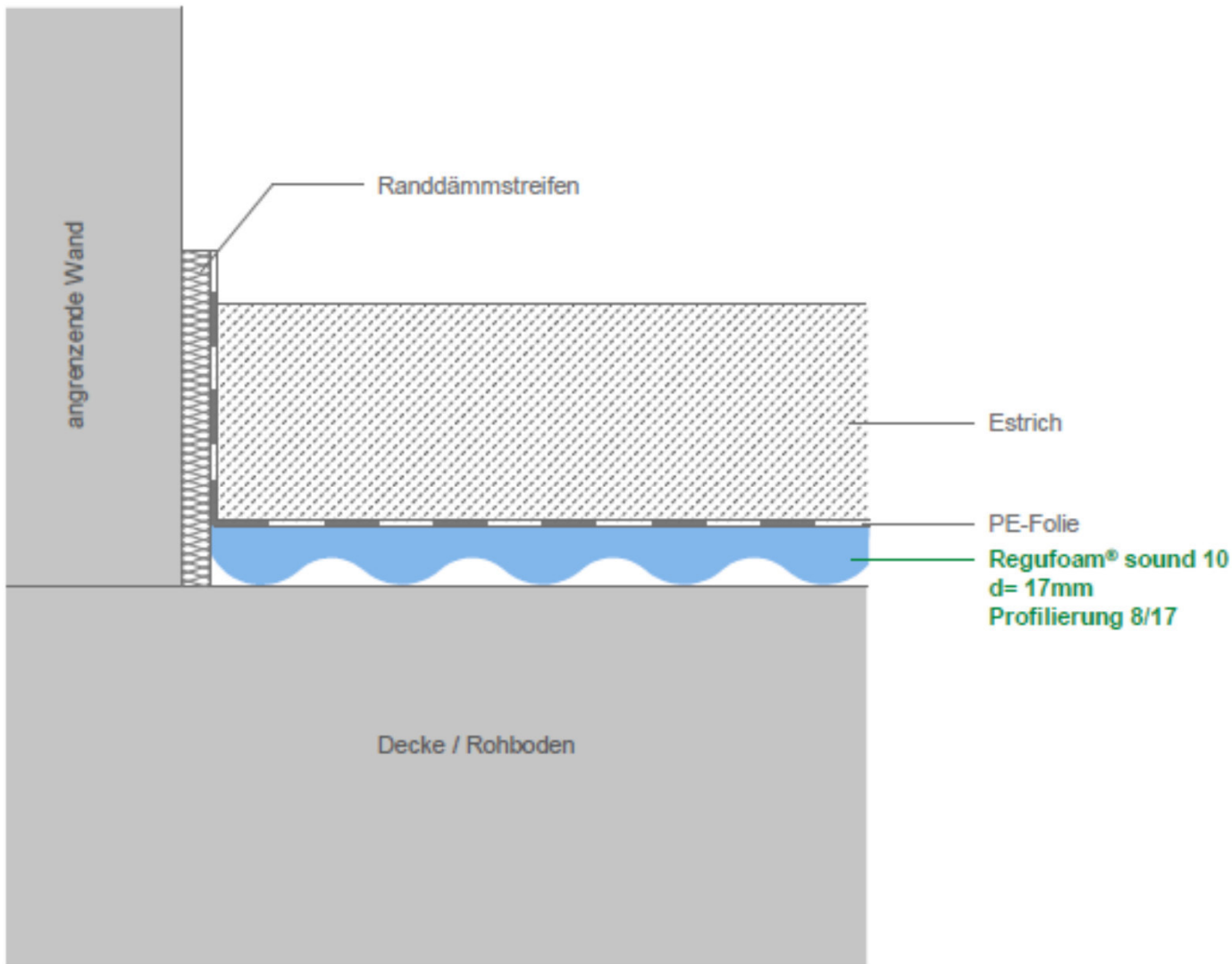

Prüfergebnis:

$$\Delta L_w = 34 \text{ dB}$$

Estriche $\geq 5 \text{ kN/m}^2$

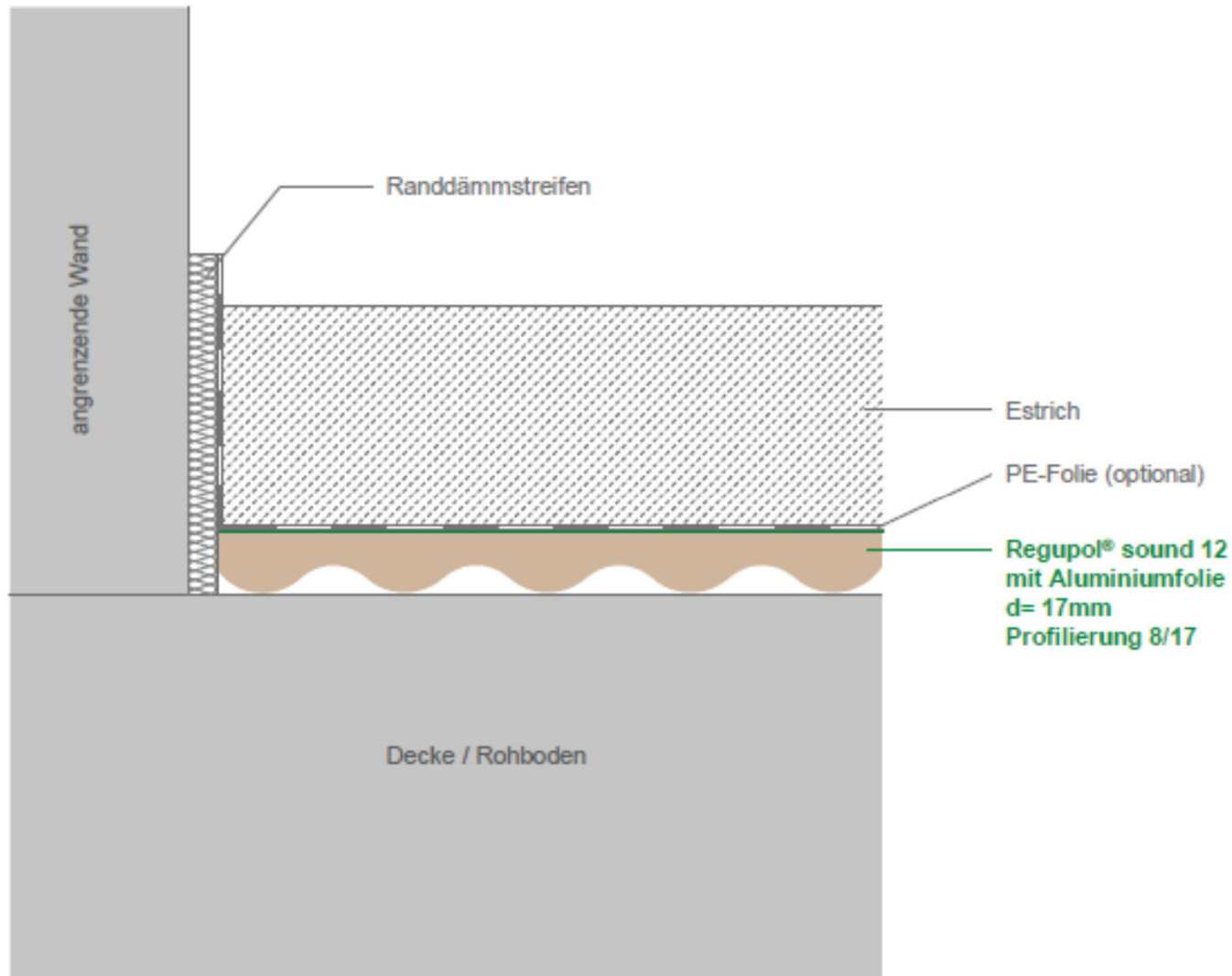

Prüfergebnis:

$$\Delta L_w = 32 \text{ dB}$$



Estriche $\geq 5 \text{ kN/m}^2$

Estriche $\geq 5 \text{ kN/m}^2$

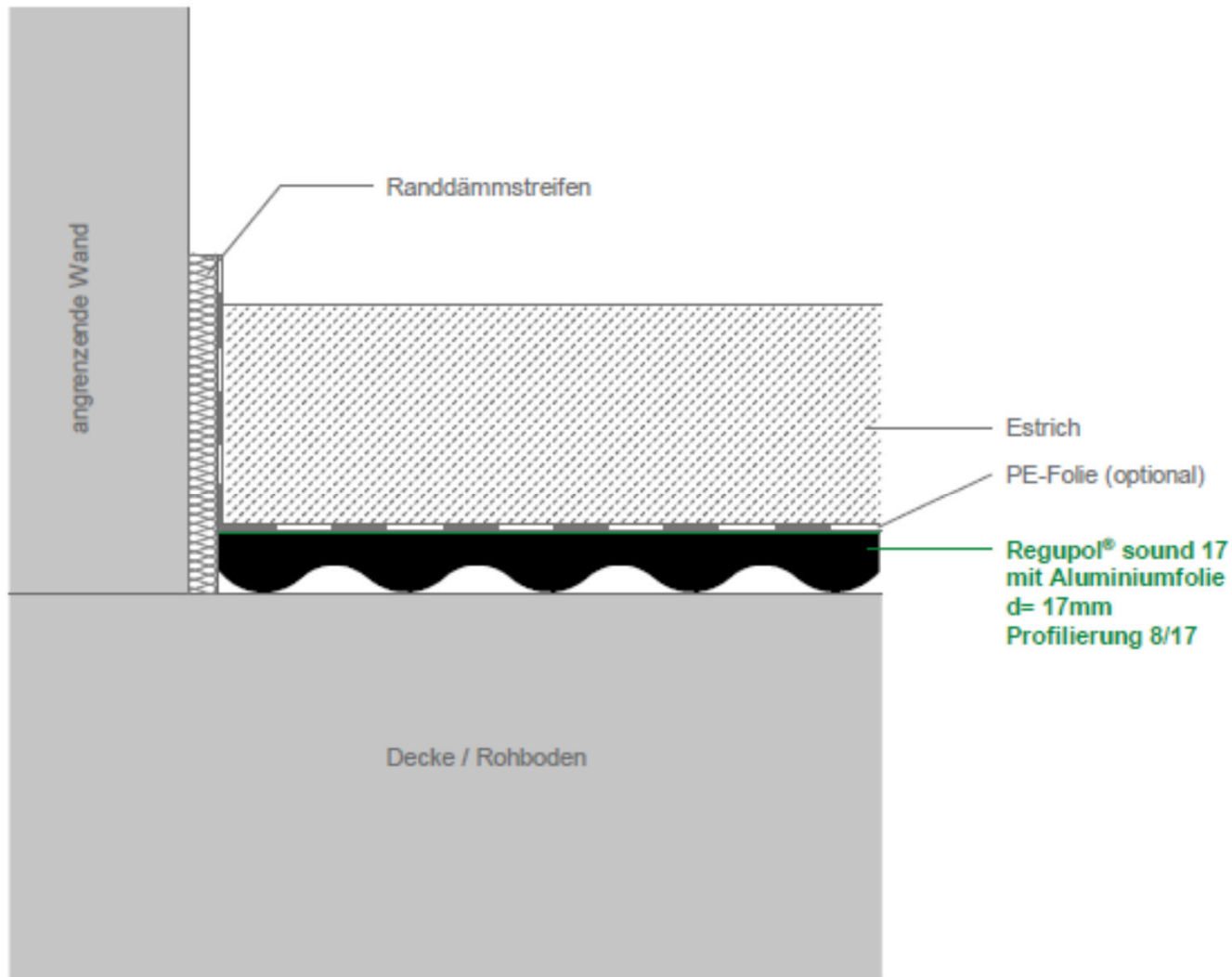

Prüfergebnis:

$$\Delta L_w = 26 \text{ dB}$$

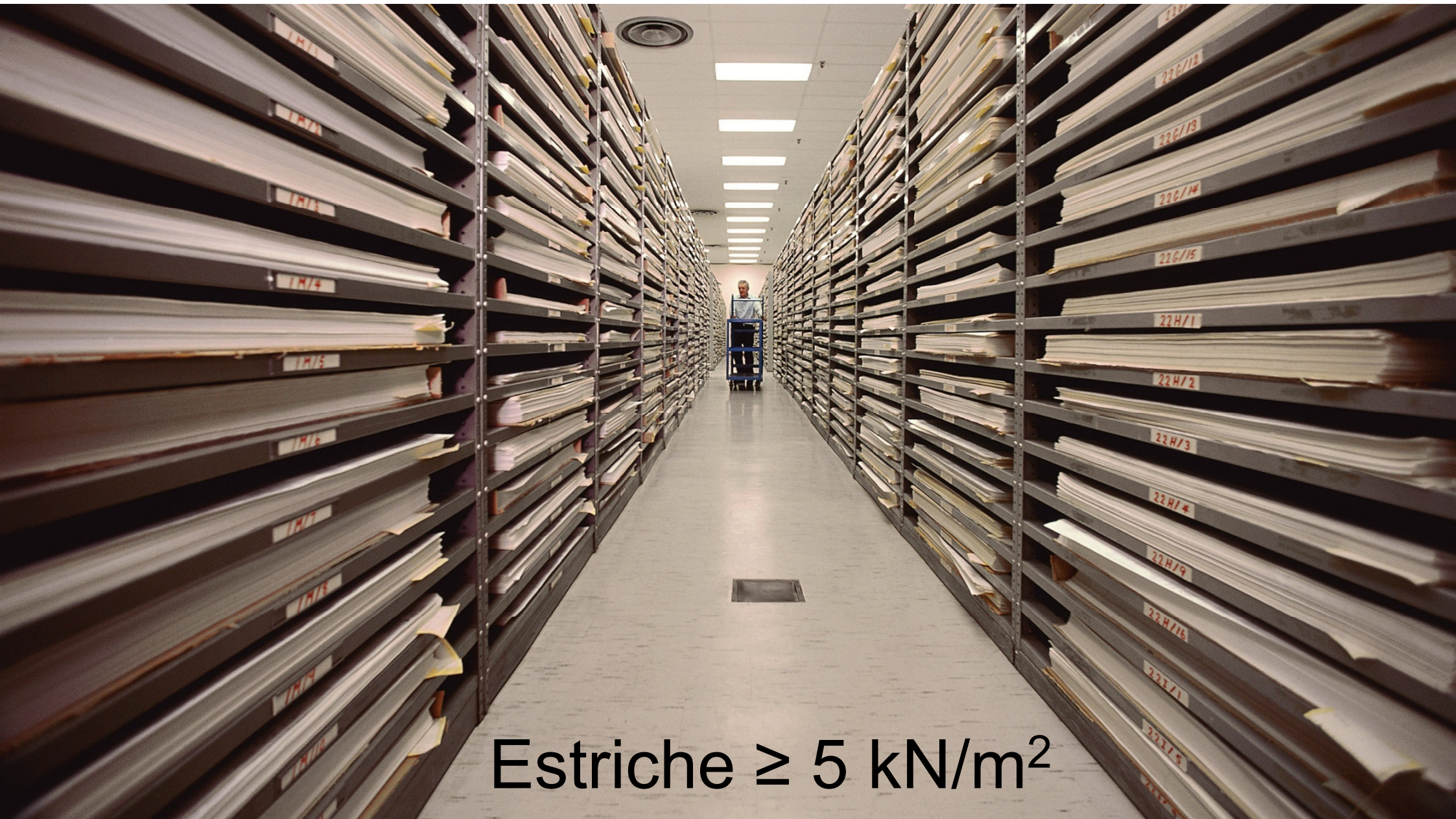

Estriche $\geq 5 \text{ kN/m}^2$

Estriche $\geq 5 \text{ kN/m}^2$

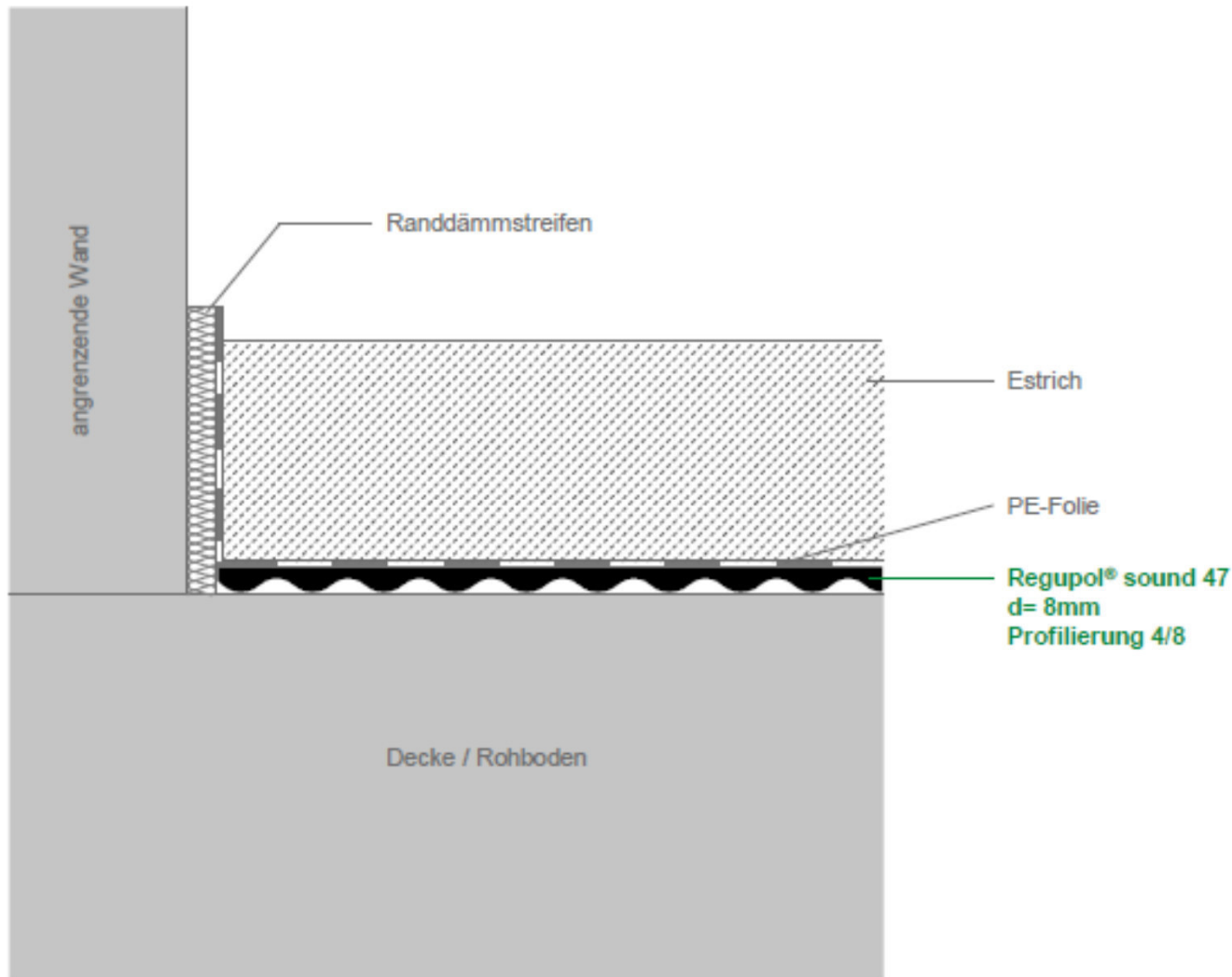

Prüfergebnis:

$$\Delta L_w = 22 \text{ dB}$$